

The button

Choose the Button to suit the screw type that works best with your panel material.

Use lime green Buttons with Ø5mm countersunk wood screws. Use orange Buttons with Ø6.2mm Euro screws (to fit Ø5mm pilot holes).

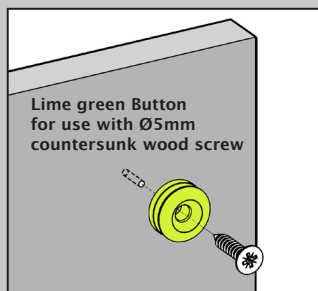

Type 1 fix

The Type 1 Fix connects parallel panels and is ideal for applications where strength and security are paramount.

Engage the Buttons in the Fixes and slide the panel down by 15mm until Button-fix goes 'click'. The Type 1 Fix can also be configured for sideways assembly.

When surface-mounted, the Type 1 Fix creates an 8mm gap between the two attaching panels.

Alternatively, you can rebate the Type 1 Fix, to reduce the gap between the two attaching panels to only 3mm.

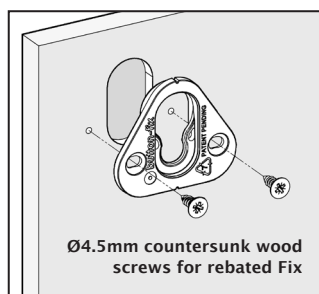
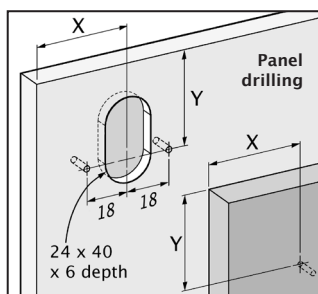
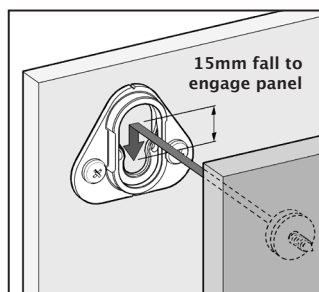
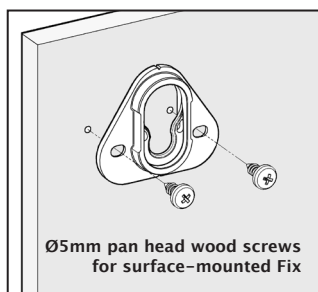

Type 2 fix

The Type 2 Fix connects panels at 90° with a simple push/pull fit. It is ideal for applications where the emphasis is more on ease of fit and less on strength. Unlike Type 1, the Type 2 Fix does not require a 15mm drop-down engagement.

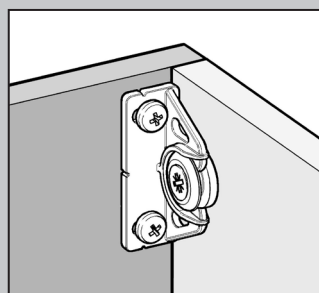
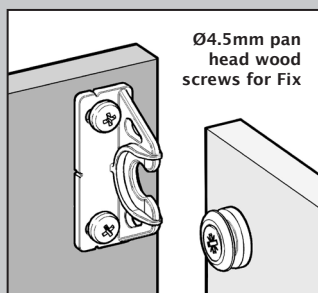

button-fix™ the secret fixing for panels

The Button-fix range of fasteners and accessories is:

Buttons

1. Lime green Button for flat head wood screws.
2. Orange Button for Euro screws.

Fixes

3. Type 1 Fix for connecting parallel panels.
4. Type 2 Fix for connecting 90° panels.

Marker accessories

5. Button marker accessory for use with Type 1 Fixes.
6. Fix marker accessory for use with Type 2 Fixes (and can also be used with Type 1).

Marker accessories need to be ordered separately from the Button-fixes.

Other accessories

7. Safety cord accessory for use with Type 2 Fixes.
8. Router jig for use when recessing Type 1 Fixes.

These accessories need to be ordered separately from the Button-fixes.

Please visit our website
www.button-fix.com for the latest product information.

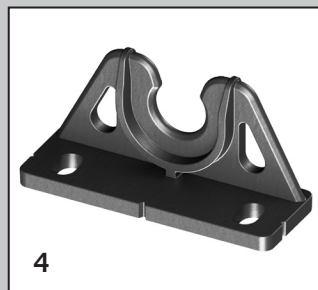
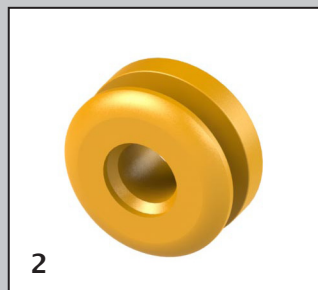

Available from: Swansea Timber & Plywood Co. Ltd
57-60 Oxford Street, Swansea SA1 3JD
Tel: 01792 720248 Email: timber@swanseatimber.co.uk

**Swansea Timber &
Plywood Co. Ltd.**